

PART NAME		MATERIAL	REMARK
FRAME	SIDE RAIL	SPA-H	
	END RAIL	SPA-H	
	CORNER POST	SM50A/SPA-H	
	CROSS MEMBER	SPA-H	
PANEL	DOOR	SPA-H	
	SIDE	SPA-H	
	FRONT	SPA-H	
WOODEN FLOOR		APITONG/HARDWOOD	
DOOR LOCKING ROD ASS'Y		"SJ-66M" TYPE	

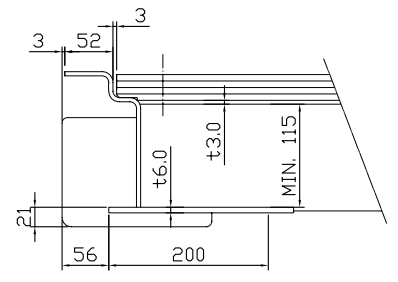

SECTION D-D
1:10

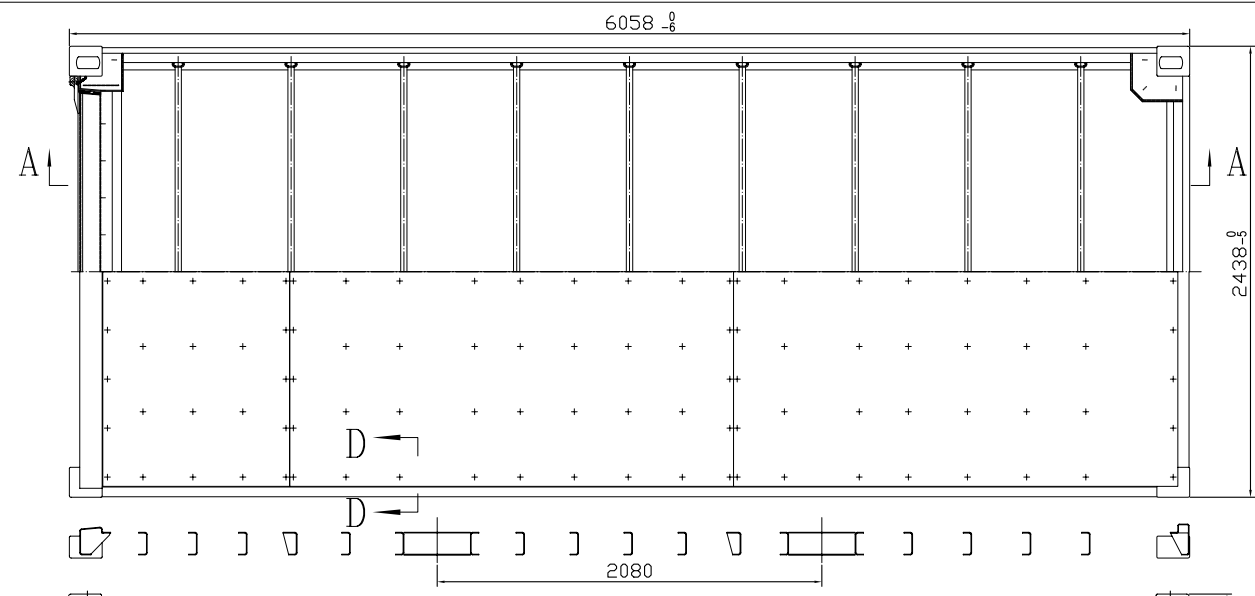
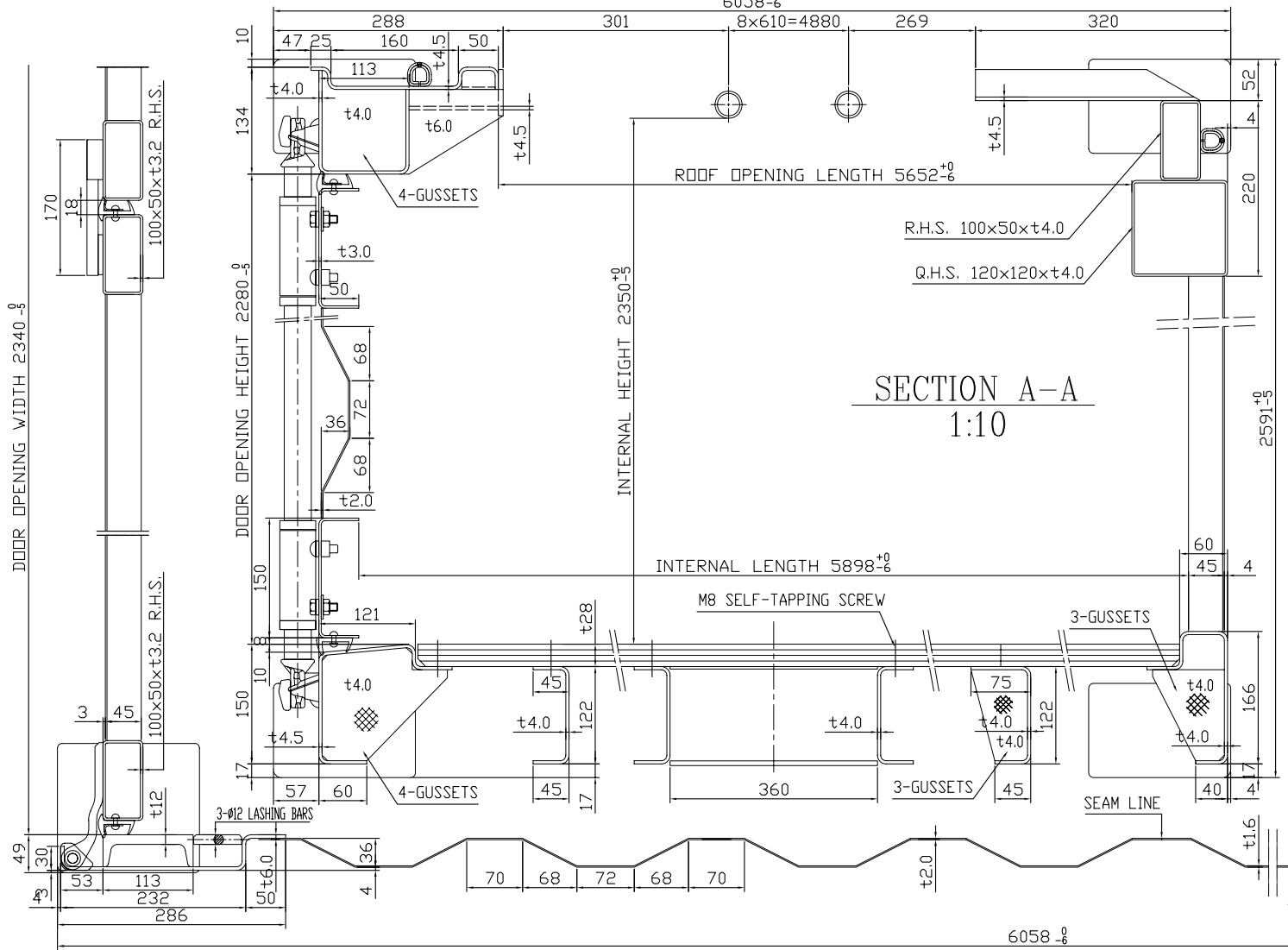
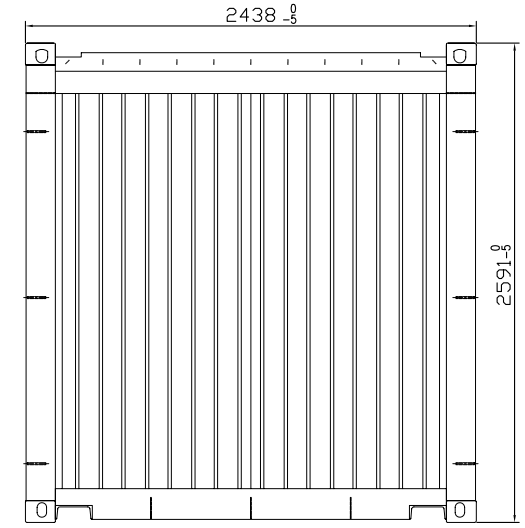
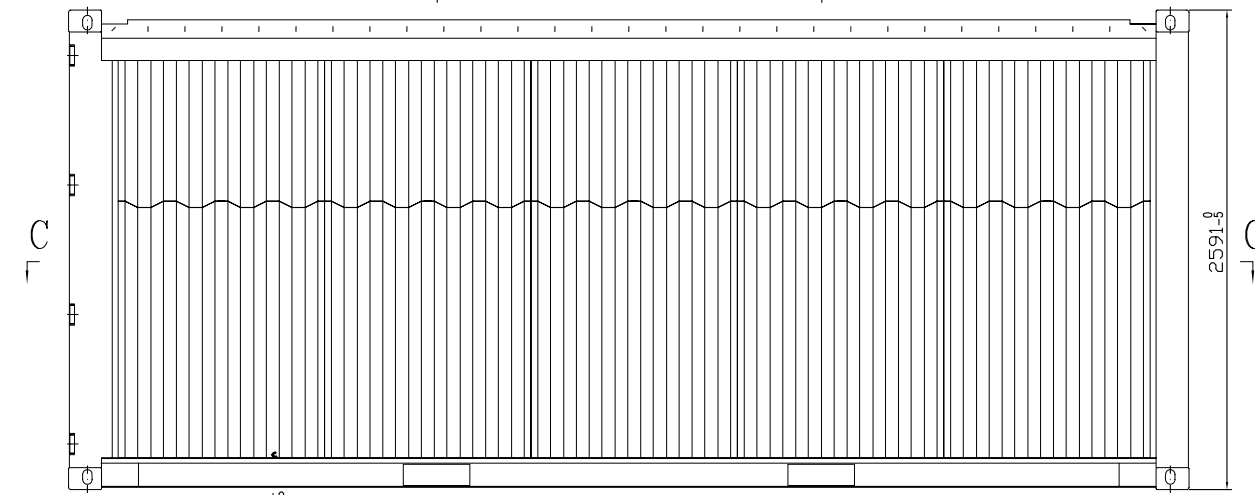
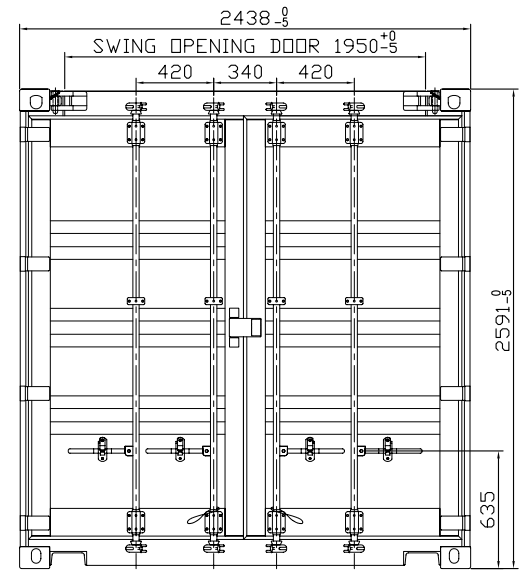

SECTION A-A
1:10

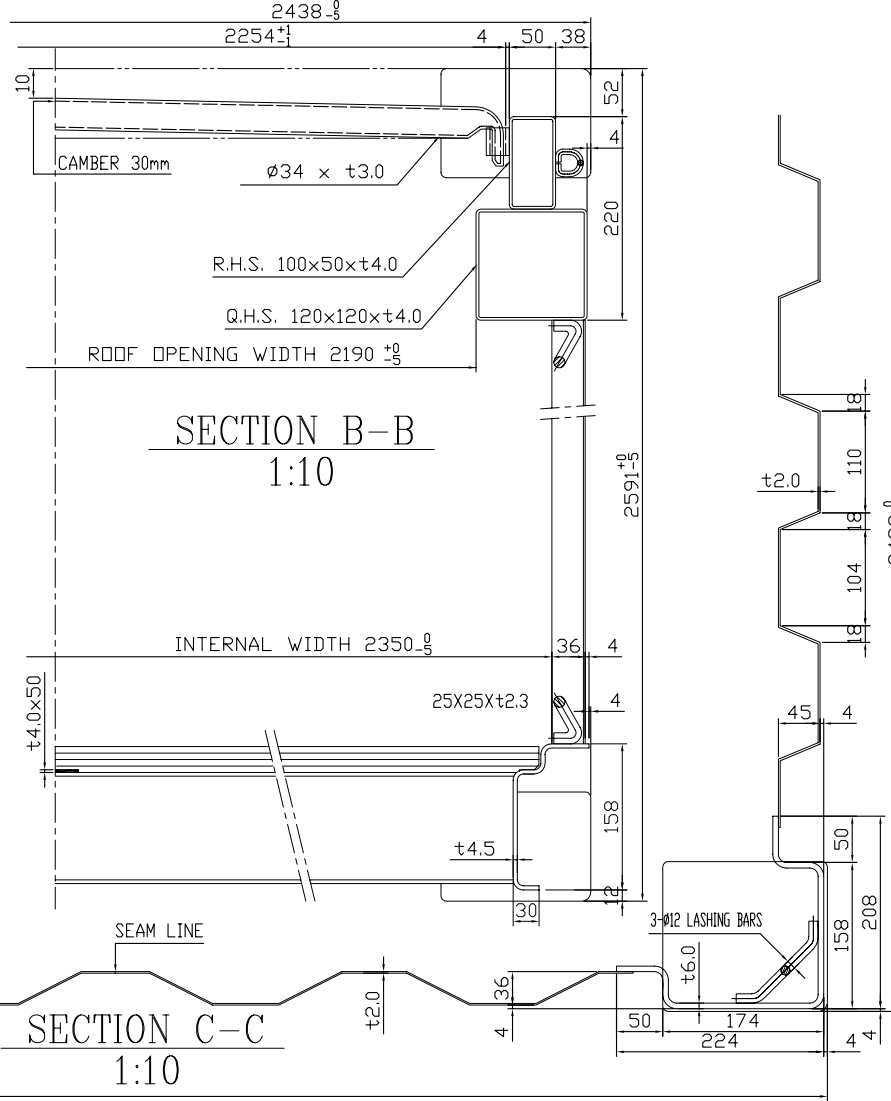

SECTION B-B
1:10

CLASSIFICATION		DIMENSION			
EXTERNAL	LENGTH	6,058	+0 -6mm	19' 10 1/2"	+0 -1/4"
	WIDTH	2,438	+0 -5mm	8' 0"	+0 -3/16"
	HEIGHT	2,591	+0 -5mm	8' 6"	+0 -3/16"
INTERNAL	LENGTH	5,898	mm	19' 4 13/64"	
	WIDTH	2,350	mm	7' 8 33/64"	
	HEIGHT	2,350	mm	7' 8 33/64"	
DOOR OPENING	WIDTH	2,340	mm	7' 8 1/8"	
	HEIGHT	2,280	mm	7' 5 49/64"	
ROOF OPENING	WIDTH	2,190	mm	7' 2 1/4"	
	LENGTH	5,652	mm	18' 6 9/16"	
INTERNAL CUBIC CAPACITY		32.6	CU.m	1,150	CU.ft
MAXIMUM GROSS WEIGHT		30,480	kg	67,200	lb
TARE WEIGHT		2,250	kg	4,960	lb
MAXIMUM PAYLOAD		28,230	kg	62,240	lb
STACKING TEST LOAD(PER POST)		86,400	kg	190,480	lb
FLOOR STRENGTH LOAD		7,260	kg	16,000	lb

DRAWING NO.	DESCRIPTION	REMARK
RXTC-20BZX-100G	BASE ASSEMBLY	
RXTC-20RKD-200-1	DOOR ASSEMBLY	
RXTC-20RKD-300	ROOF ASSEMBLY	
RXTC-20RKD-400-1	SIDE ASSEMBLY	R/H:1 L/H:1
RXTC-20RKD-500	FRONT ASSEMBLY	
RXTC-40RDX-600	SWING HEADER & CORNER TROUGH	

TITLE:		OWNER
GENERAL ASSEMBLY		ISO-1CC 20'x8'x8'6"
总图		WT(KG)
		SCALE

DESIGNED	APPROVED	DRAWING NO.	OWNER
		RXTC-20RKD-000-1	张家港日新通物流装备有限公司